



# WUE-800E



## Introduction

### Overview

WUE-800E は、EN 50155, EN 50121-4 の要求に準拠しており、鉄道・線路沿や、鉄道車両、車両等の輸送業界でのセキュアな通信用途向けにデザインされたアンマネージドスイッチです。WUE-800E は、Industrial 8ポートの10/100Base-T(X) を有しており、さらに広域温度モデル (-40 to 80°C) をサポートしております。IP67レートにより、ダスト・湿気・油や水の浸入に対する耐性を持っています。搭載されるM12コネクタにより水密を保持し、振動や衝撃等の悪環境下でも確実なコネクションを実現します。安全性のために12/24/48VDC冗長電源入力をサポートしています。WUE-800E の特徴の1つは、リニアバスポロジータで1つ以上の電源ノードが故障した場合のネットワークのロスを防ぐために内蔵されている2つのバイパスポートです。

## Features

### High Performance Network Switching Technology

- Complies with IEEE standards
- Provides 8 x 10/100Base-T(X) with M12 connector (4-pin, female, D-Coded)
- Supports broadcast storm protection
- Built-in 2 bypass ports to avoid one or more nodes power failure in a linear bus topology to avoid data loss

### Reliable Power Design

- Equipped with redundant power inputs
- Supports 12/24/48VDC power input with IP67 M12 connector (5-pin, male, A-Coded)
- Power reverse polarity protection and overload current protection

### Robust Industrial Design

- EN 50155 certified for Railway Applications and IEC 61373 test passed for vibration and shock resistant
- EN 50121-4 certified for Railway Applications (Track Side)
- EN 61000-6-2 and EN 61000-6-4 certified to use in heavy industrial environment
- Robust industrial design case complies with IP67 housing standard
- Supports operating temperature -40 to 80°C
- Wall mount or DIN-Rail mounting installation

## Specifications

### Hardware Specifications

#### Interface

**Total Ports:** 8 ports

**M12 Ports:** 8 x 10/100Base-T(X) M12 connector (4-pin, female, D-Coded), auto-negotiation

speed, Full/Half duplex, auto MDI/MDI-X

**LEDs:** System: Power 1 (Green), Power 2 (Green)

M12 Ports: 10/100 Link/Active (Green)

#### Power Requirements

**Power Input:** 12 to 48VDC, M12 (5-pin, male, A-Coded), redundant dual inputs

**Power Consumption:** 12VDC/1.8W, 24VDC/2.2W, 48VDC/3.4W

**Power Protection:** Reverse polarity protection, overload current protection

#### Physical

**Dimensions:** IP67 standard, 65.1mm (W) x 191.5mm (H) x 39mm (D)

**Installation:** Wall mount or DIN-Rail mounting

#### Environmental

**Operating Temperature:** -40 to 80°C

**Storage Temperature:** -40 to 85°C

**Operating Humidity:** 5% to 95% RH (Non-condensing)

#### Technical

##### Standard:

IEEE 802.3 10Base-T Ethernet

IEEE 802.3u 100Base-TX/100Base-FX

IEEE 802.3x Flow Control

**Protocol Technology:** CSMA/CD

**Switching Architecture:** Store and Forward

#### Regulatory Approvals

**EMI:** FCC Part 15 Subpart B Class A, CE EN55022 Class A

**EMC:** CE, EN 61000-6-2, EN 61000-6-4

**EMS:** EN 61000-4-2, EN 61000-4-3, EN 61000-4-4, EN 61000-4-5, EN 61000-4-6, EN 61000-4-8,

**Railway Application:** EN 50155 (Certified)

**Railway Application (Track Side):** EN 50121-4 (Certified)

**Shock:** IEC 61373

**Vibration:** IEC 61373

**Free Fall:** IEC 60068-2-32

**Environmental:** WEEE, RoHS

**MTBF:** 1,492,660 hours based on Mil-Hdbk-217F, GB

**Warranty:** 5 years

Dimensions (unit=mm)

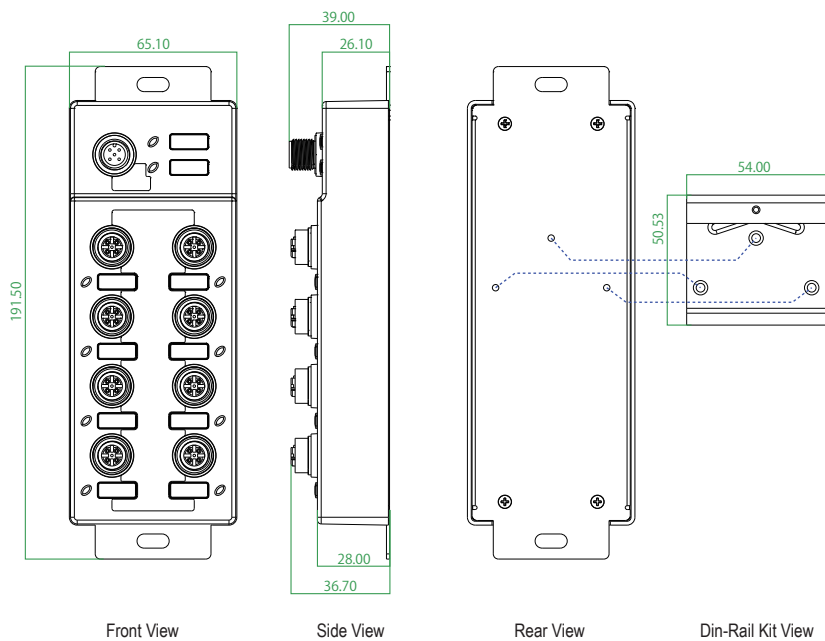

Ordering Information

WUE-800E

Industrial 8 x 10/100Base-T(X) EN 50155 IP67 M12 Unmanaged Ethernet Switch, -40 to 80°C

**BASIC JAPAN**

Basic Japan株式会社 Suginami Tokyo, Japan

Phone: 03-5335-7651

E-mail: mail@basicjp.com

URL: www.basicjp.com